

MEDICAL LOCKABLE LINE VALVE

Specifications

- 2 piece in-line easy to service
- Available in sizes 15mm to 108mm
- Full port ball valve
- Ends capped and sealed in a plastic bag to prevent contamination prior to installation
- Adjustable packing with blow-out proof stem
- Working pressure rating of PN25
- Brass body
- European standard copper tube extensions
- Non-lockable versions are also available
- 100% tested
- ISO9001:2015



Materials

Part Name	Material	Part Name	Material
Body	Brass	Welded Junction	Brass
Stem	Brass	Hex Nut	Brass
Bonnet	Brass	Seal	PTFE
Ball	Brass	Packing	PTFE
Lock Nut	Brass	Washer	PTFE

Dimensions

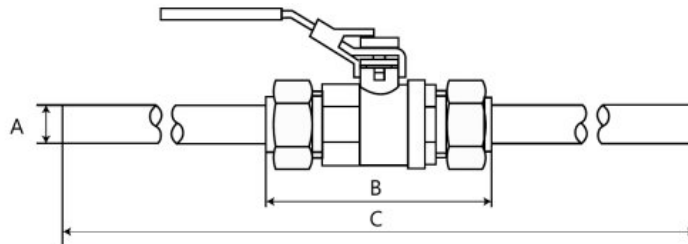

Part Number	Size (mm)	Overall Length (mm)
AMDLV01L	15	362
AMDLV02L	22	475
AMDLV03L	28	475
AMDLV04L	35	563
AMDLV05L	42	570
AMDLV06L	54	594
AMDLV07L	76	785
AMDLV08L	108	985

Features

- 3 piece brass ball valve.
- Available in sizes 1/2"-4"
- Dual gauge/purge ports 1/8 FNPT
- Full port 1/4 turn ball valve
- Cleaned for Oxygen service, ends capped and sealed in a plastic bag to prevent contamination prior to installation
- Adjustable packing with blow-out proof stem
- Working pressure rating of 600psi WOG
- Brass body
- Type"K" copper tube extensions.
- Optional locking handles available
- 100% tested

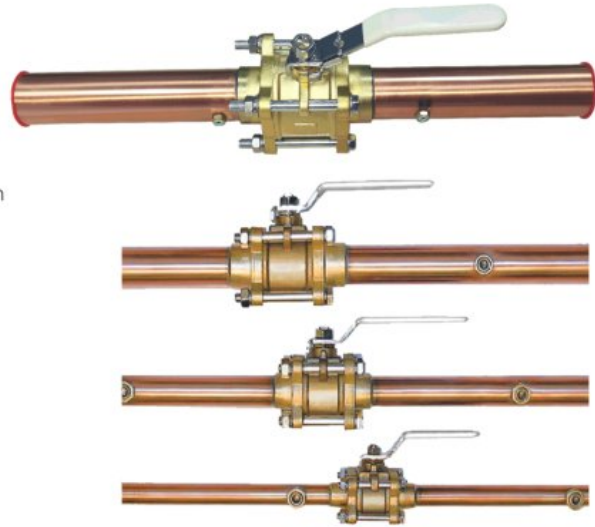

Dimensions

Note: Gauge port supplied w/ 1/8"NPT Plug

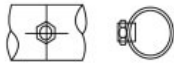

Gauge Port Design

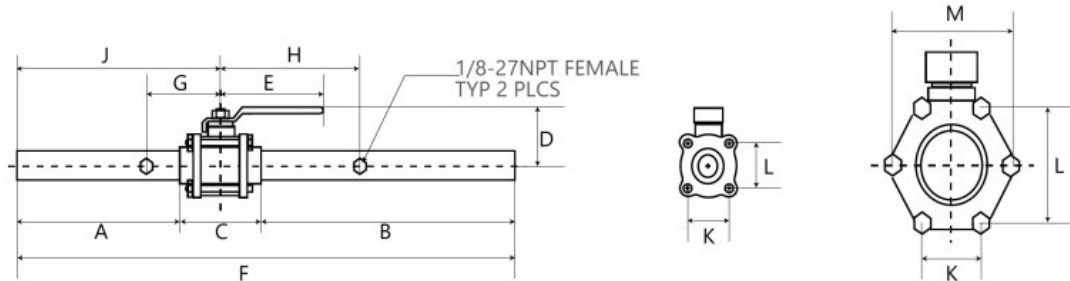

For 2-1/2" ,3and 4" use 6 bolts configuration and rest will be 4 bolt configurations.

Ball Valve Assemblies

Size Valve	Standard Handle Part#	w/ Locking Handle Part#	Dimensions (Inch)												
			A	B	C	D	E	F	G	H	J	K	L	M	
1/2"	AMDBVT-02	AMDBVT-02L	8.25	11.75	3.02	1.85	3.75	23.02	2.38	6.38	9.76	1.40	0.81	-	
3/4"	AMDBVT-03	AMDBVT-03L	8.44	11.00	3.56	2.19	4.50	23.00	2.69	6.06	10.22	1.52	1.52	-	
1"	AMDBVT-04	AMDBVT-04L	8.69	10.50	3.81	2.64	4.80	23.00	2.88	5.88	10.60	1.80	1.80	-	
1 1/4"	AMDBVT-05	AMDBVT-05L	8.63	9.75	4.66	2.78	4.80	23.04	3.25	5.50	10.96	2.17	2.17	-	
1 1/2"	AMDBVT-06	AMDBVT-06L	9.00	9.75	5.00	2.95	4.80	23.75	3.38	5.38	11.50	2.38	2.38	-	
2"	AMDBVT-07	AMDBVT-07L	9.56	9.25	5.70	3.64	4.80	24.51	3.75	5.00	12.41	3.00	3.00	-	
2 1/2"	AMDBVT-08	AMDBVT-08L	12.50	12.50	7.00	5.22	8.00	32.00	4.25	4.25	16.00	2.69	4.66	5.38	
3"	AMDBVT-09	AMDBVT-09L	12.22	12.22	7.56	4.61	9.06	32.00	4.50	4.50	16.00	2.75	4.73	5.00	
4"	AMDBVT-10	AMDBVT-10L	11.10	11.10	9.80	7.00	12.00	32.00	8.00	8.00	16.00	3.75	6.50	7.50	

AMCAREMED TECHNOLOGY CO.,LIMITED

Email: info@amcaremed.com | Web: www.amcaremed.com | Tel: +86 550 7111326
 Add: Building 30, SuDa Tiangong Science Park, Chuzhou, Anhui Province,China